



Version 1.0

Leica Rugby 870/880 Quick Start

- when it has to be **right**



Rugby 880

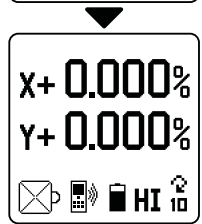
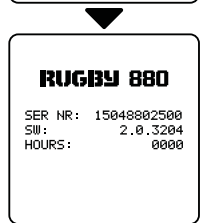
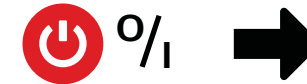

Rugby 870

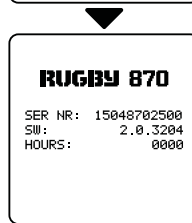
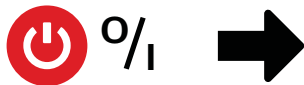

Rugby 870 X-axis grade entry

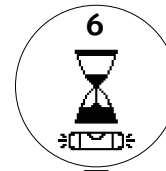
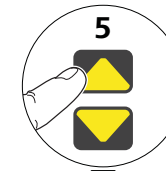
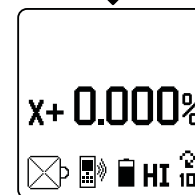
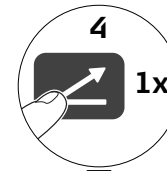
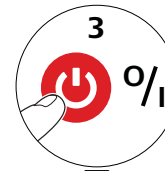

Rugby 880 X-axis grade entry

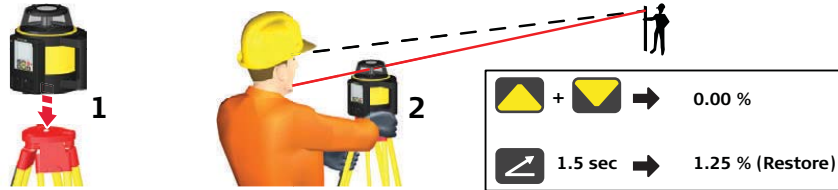
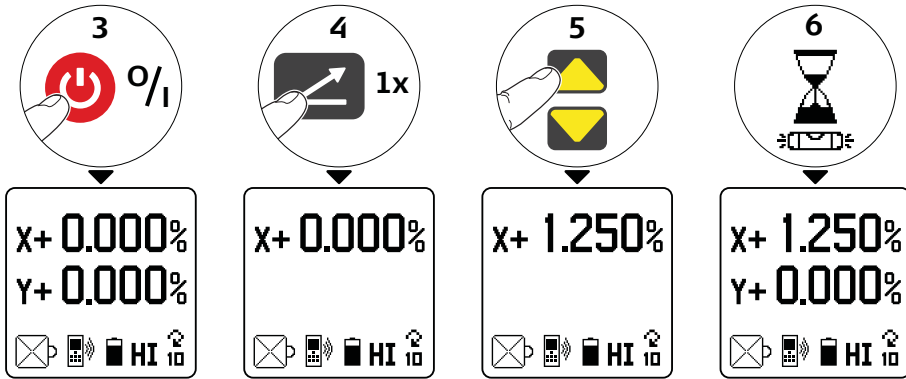

Grade entry by digit

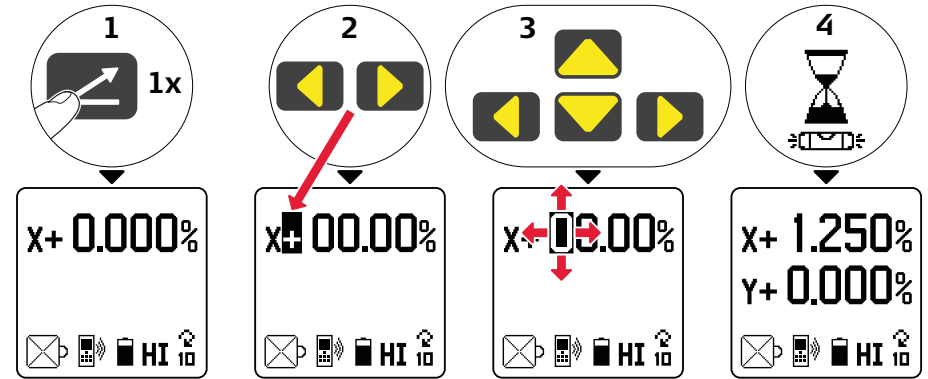

Section 3.4

Rugby 880 Y-axis grade entry

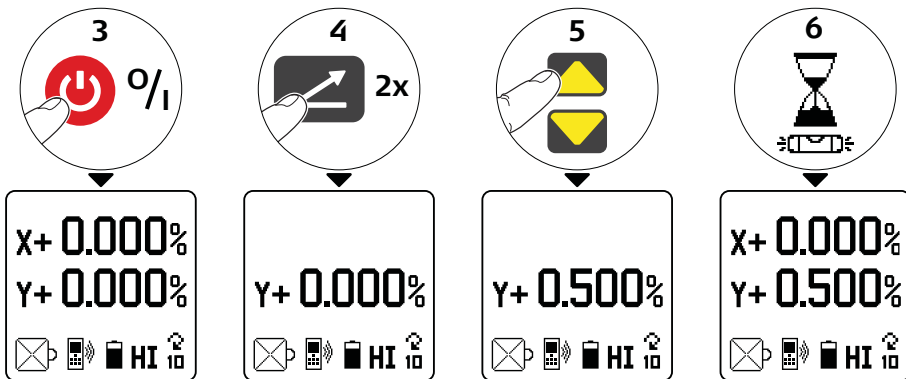

Rugby Menu

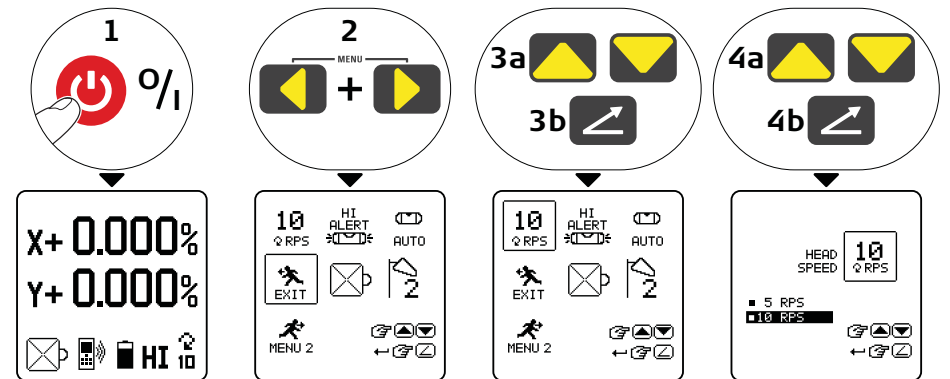

Section 6.0

Beam Masking

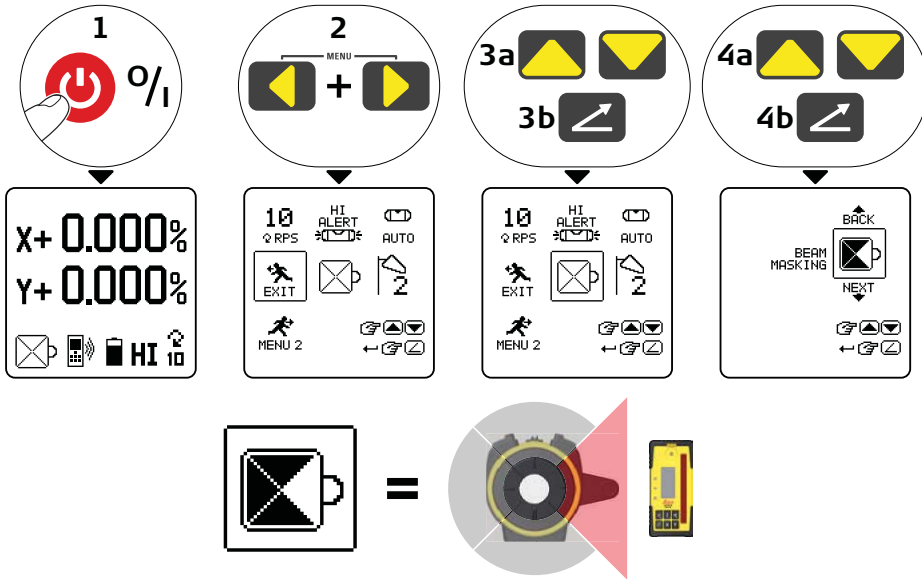

Batteries

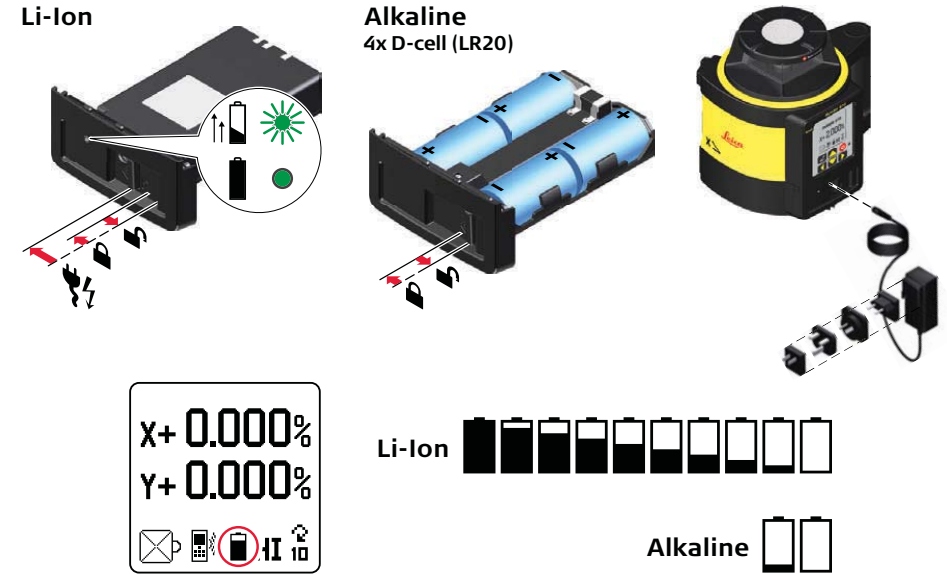

Alerts

TEMPERATURE ALERT

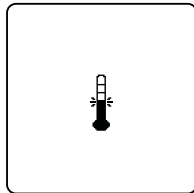

> +50°C < -20°C

H.I. ALERT

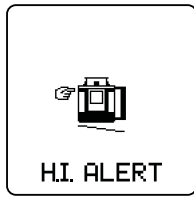
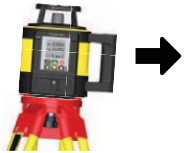

① %/1
② check HI

TEMPERATURE CHECK ALERT

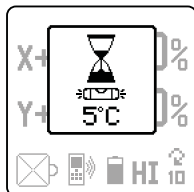

~ 2 min

Rod Eye 140, Classic



	%/1
	±1 mm, ±2 mm, ±3 mm

Rod Eye 160, Digital



	%/1
	±0.5 mm, ±1 mm, ±2 mm, ±3 mm, ±5 mm
1x	mm 0.22

Rod Eye 180, Digital RF



	%
	±0.5 mm, ±1 mm, ±2 mm, ±3 mm, ±5 mm
1x	mm 022
1.5 s	Smart Target SMT ▶ XSC
5 s	Smart Target Lock SML ▶ XSL ▶ LOC

Rod Eye 180 and RC800 Remote Batteries and Pairing



Alkaline
2x AA-cell
(LR6)

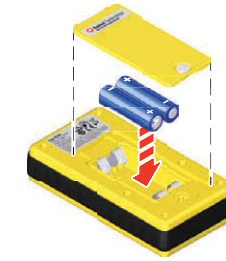

Alkaline
2x AA-cell
(LR6)

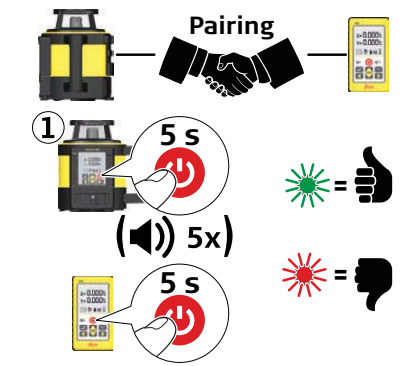
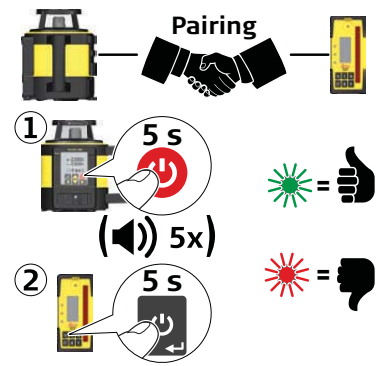

RC800 Remote Control



Section 4.0 / 7.0

	%
	2h
1.5 s	

Setting Forms

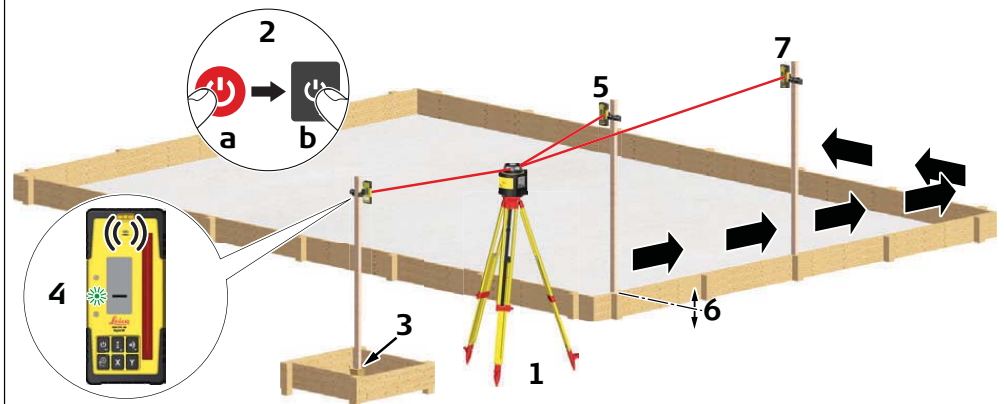
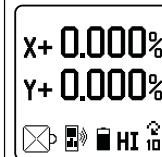

Section 8.1

Checking Grades

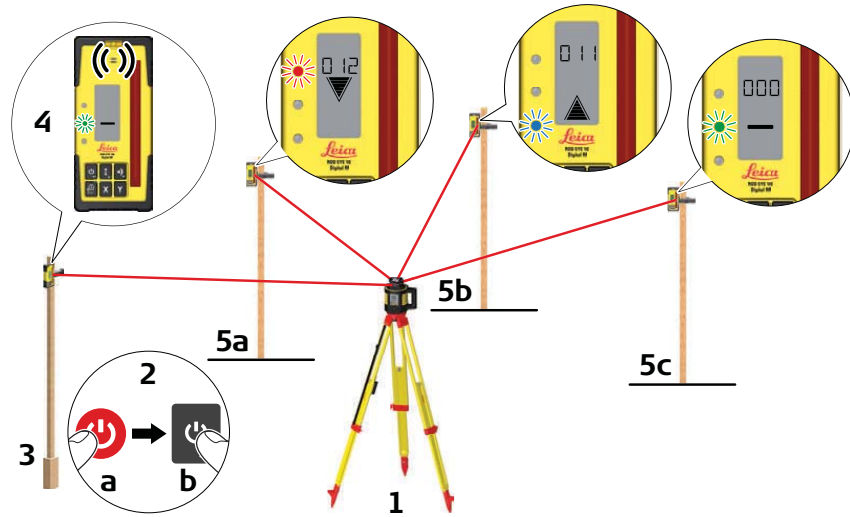

Section 8.2

Automatic Axis Alignment, Rod Eye 180 Digital RF

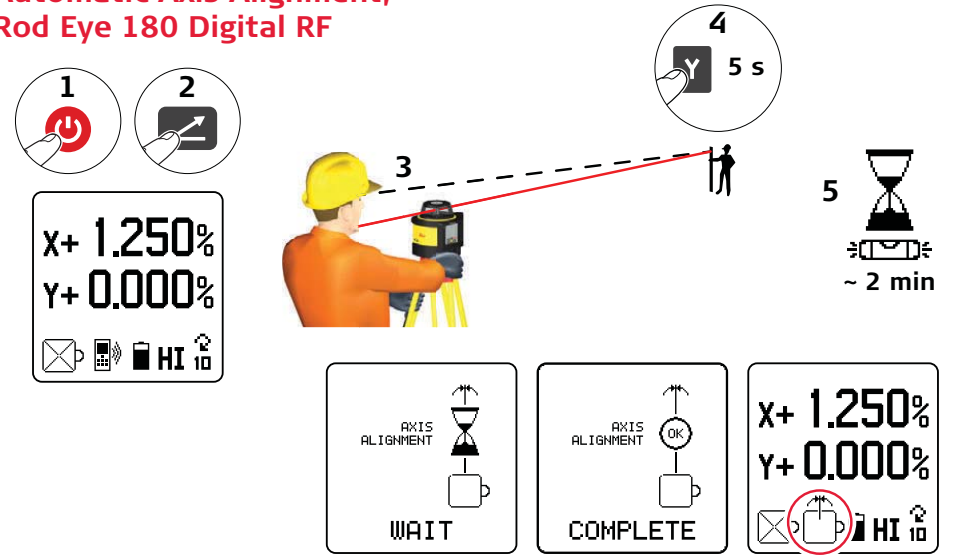

Section 8.6

Smart Target, Rod Eye 180 Digital RF

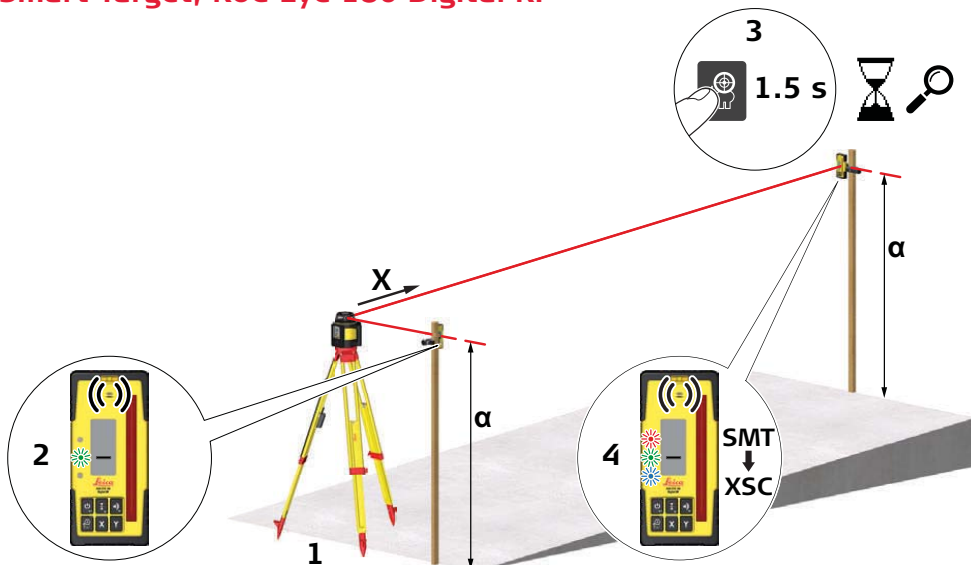

Section 8.4 / 8.5



Laser class 1 product in accordance with IEC 60825-1 (2014-05)

Leica Geosystems AG
Heinrich-Wild-Strasse
CH-9435 Heerbrugg
Switzerland
Phone +41 71 727 31 31
www.leica-geosystems.com

- when it has to be right

Leica
Geosystems

804346-1.0.0
Original text
© 2014 Leica Geosystems AG, Heerbrugg, Switzerland